

High Street

£1,100 PCM

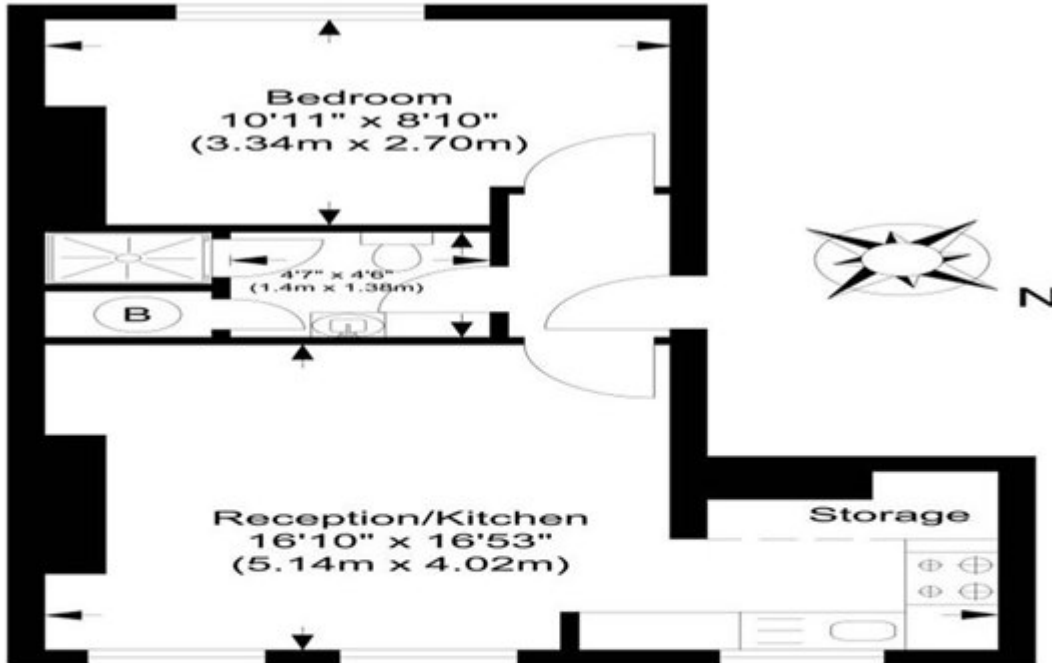

High Street, Harlesden, NW10
Approx. Gross Internal Area
(not including Storage)
328.83 sq. ft.
(30.55 sq. m)

Whilst every attempt has been made to ensure the accuracy of the floor plans contained here, measurements of doors, windows and rooms are approximate and not to scale and no responsibility is taken for any error, omission or mis-statement. These plans are for representation purposes only and should be used as such by any prospective purchaser or tenant.
Floor plan created by Highgate Energy - info@Highgate-Energy.com - 07870 688 760